

# Afaria 7 - Update to SP6

**Author :** Tobias Hofmann

**Date :** September 24, 2015

Blogs with content referred to by this blog:

1. [Install Afaria Server](#)
2. [Install Afaria API Service and Administrator](#)
3. [Install Self Service Portal](#)
4. [Install Enrollment Server](#)
5. [Install Package Server](#)
6. [Validation of Afaria 7 SP6](#)

## Afaria 7 SP6 update

[Afaria 7 SP6 is available](#) as of 11. September 2015 and can be downloaded from [SAP Support Portal](#). The pre-requisite for installing SP6 is [having SP5 installed](#). Its a 326MB download. The size already implies that you cannot install SP6 without having Afaria 7 already installed.

<a href="#">AFARIA70006_0-21010386.ZIP</a>	Afaria 7.0 Service Pack 6	<a href="#">Info</a>	326108	11.09.2015
--	---------------------------	----------------------	--------	------------

Download the file (AFARIA70006\_0-21010386.zip) and copy it over to your Afaria 7 server. The ZIP contains all the files for all the components going to be updated.

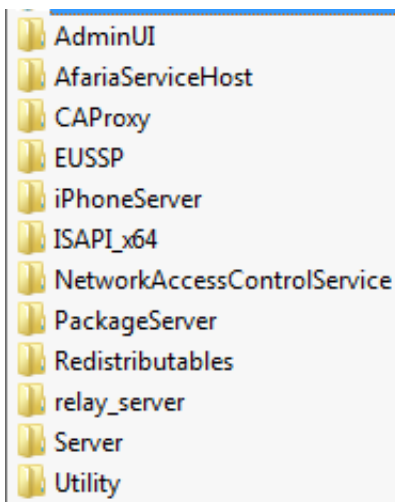

Before starting installation check that your current Afaria 7 SP5 installation is working:

## It's full of stars!

Where documentation meets reality



## Start update

Run setup.exe

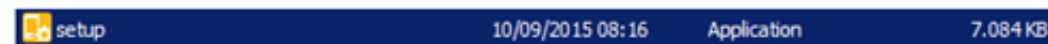

Initializing setup. Please wait....

Choose language

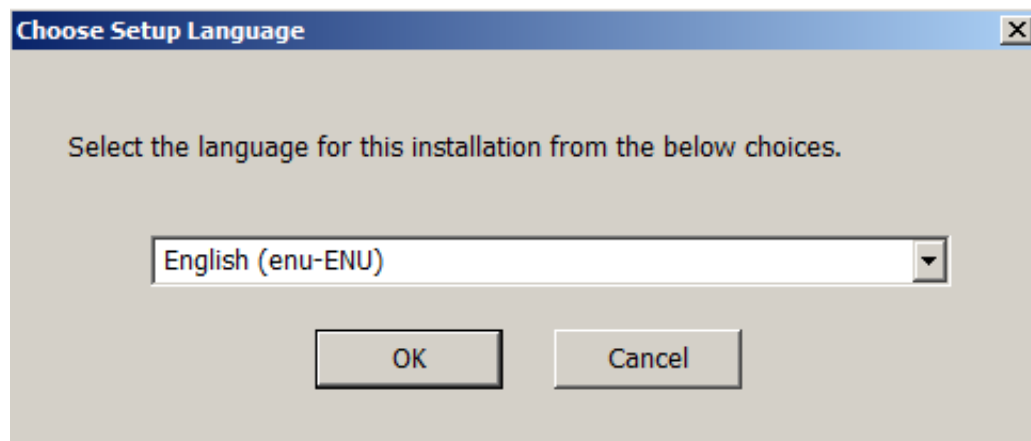

## Check your license key

## It's full of stars!

Where documentation meets reality



Item	Value
System Serial Number	50185
Maximum concurrent sessions	Unlimited
Server was installed on	29/12/2014
Windows Client	
Windows Session Manager	Licensed
Windows Inventory Manager	Licensed
Windows Mobile Professional Client	

## Readiness check

If your license is OK, start the readiness check

## It's full of stars!

Where documentation meets reality



Select what you want to test and start the test by clicking on "Test Now".

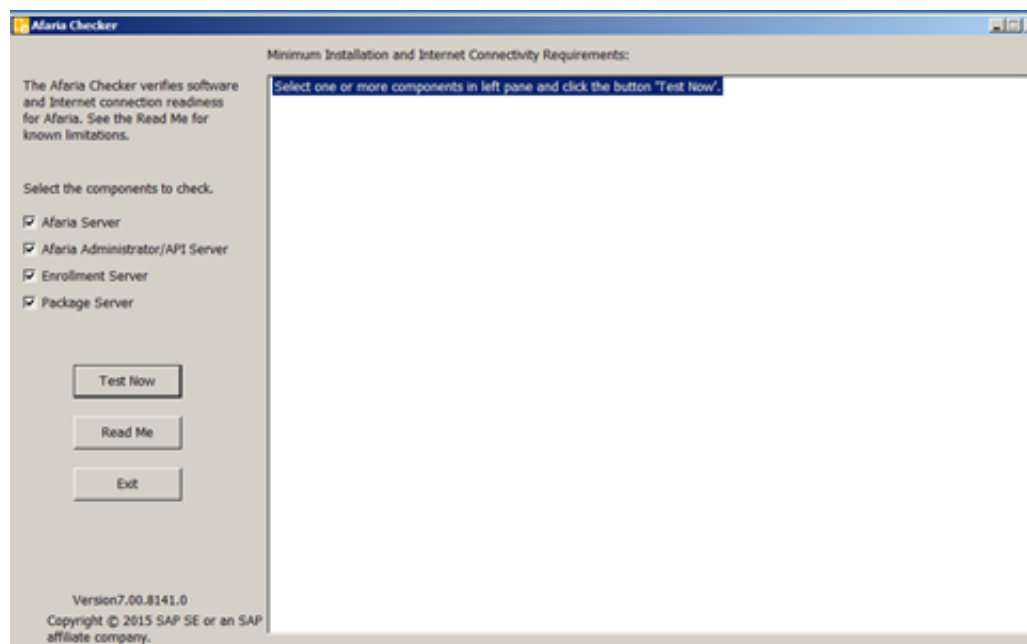

The tests are executed. This can take some while to finish.

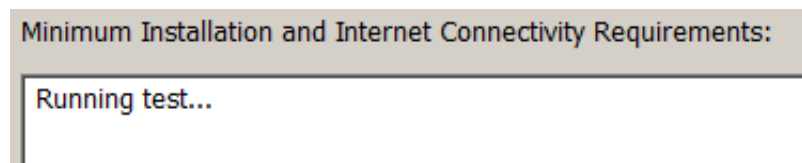

If the test finishes, you should see as a result that all requirements are satisfied.

## It's full of stars!

Where documentation meets reality

### Minimum Installation and Internet Connectivity Requirements:

#### Afaria Server

All requirements satisfied.

#### Afaria Administrator Server / API Server

All requirements satisfied.

#### Enrollment Server

All requirements satisfied.

#### Package Server

All requirements satisfied.

## Install/Upgrade to Afaria 7 SP6

From the setup, select the Install option.



This will show you a screen with all the components that can be upgraded with the installer.



From this screen on you'll have to start the update process for each component you have installed on your server.

1. [Install Afaria Server](#)
2. [Install Afaria API Service and Administrator](#)
3. [Install Self Service Portal](#)
4. [Install Enrollment Server](#)
5. [Install Package Server](#)

## Additional Installations and Resources



Select what you need to install.

## VALIDATE UPDATE

1. [Validation of Afaria 7 SP6](#)